



ROGER C. PETTINGELL

office: 941.387.1840 cell: 941.586.6668 toll free: 800.910.8728 fax: 941.387.0173
 e-mail: realroger@comcast.net website: longboatrealstate.com

Luxury Waterfront Specialist

Country Club Shores

► Current Market Analysis
 October 23, 2008

ACTIVE LISTINGS

| | PRICE | SQ. FT. | PRICE/SQ. FT. |
|-------------------------------|------------------|--------------|---------------|
| 540 Putter Lane | \$909,000 | 2,083 | \$436 |
| 601 Putter Lane | 5,499,000 | 5,950 | 924 |
| 520 Golf Links Lane | 1,297,000 | 2,016 | 643 |
| 550 Chipping Lane | 1,195,000 | 2,272 | 525 |
| 570 Wedge Lane | 1,150,000 | 2,248 | 511 |
| 530 Birdie Lane | 775,000 | 1,447 | 536 |
| 541 Birdie Lane | 895,000 | 1,570 | 570 |
| 571 Birdie Lane | 1,395,000 | 2,853 | 489 |
| 580 Birdie Lane | 929,000 | 1,977 | 470 |
| 541 Putting Green Lane | 799,000 | 2,741 | 291 |
| 560 Putting Green Lane | 919,000 | 1,616 | 569 |
| 580 Putting Green Lane | 1,995,000 | 3,888 | 513 |
| 1015 Bogey Lane | 2,495,000 | 4,405 | 566 |
| 1050 Bogey Lane | 399,000 | 1,716 | 233 |
| 1125 Bogey Lane | 799,000 | 2,367 | 338 |
| 530 Yardarm Lane | 1,395,000 | 2,427 | 574 |
| 551 Yardarm Lane | 995,000 | 1,716 | 579 |
| 610 Yardarm Lane | 2,575,000 | 4,138 | 622 |
| 621 Yardarm Lane | 3,999,000 | 5,248 | 762 |
| 551 Bowsprit Lane | 1,295,000 | 2,374 | 545 |
| 570 Bowsprit Lane | 895,000 | 1,828 | 490 |
| 532 Ranger Lane | 869,000 | lot | N/A |
| 552 Ranger Lane | 785,000 | 1,411 | 556 |
| 621 Ranger Lane | 995,000 | 1,958 | 508 |
| 632 Ranger Lane | 3,199,000 | 4,205 | 760 |
| 561 Halyard Lane | 1,150,000 | 1,997 | 575 |
| 596 Halyard Lane | 2,300,000 | lot | N/A |
| 608 Halyard Lane | 2,399,000 | 1,924 | 1,246 |
| 657 Halyard Lane | 2,695,000 | 4,364 | 618 |
| 525 Hornblower Lane | 598,500 | 2,240 | 267 |
| 549 Hornblower Lane | 2,395,000 | 4,051 | 591 |
| 560 Hornblower Lane | 2,845,000 | 4,199 | 678 |
| 501 Gunwale Lane | 589,900 | 2,223 | 265 |
| 513 Gunwale Lane | 799,000 | 2,159 | 370 |
| 524 Gunwale Lane | 1,300,000 | 2,135 | 608 |
| 501 Outrigger Lane | 520,000 | 2,137 | 243 |
| 512 Cutter Lane | 799,000 | 1,592 | 501 |
| 573 Cutter Lane | 1,795,000 | 3,500 | 513 |
| 573 Yawl Lane | 1,999,000 | 3,247 | 615 |
| 500 Schooner Lane | 895,000 | 1,657 | 540 |
| 524 Schooner Lane | 2,999,000 | 4,400 | 682 |
| 537 Schooner Lane | 1,299,000 | 2,402 | 541 |
| 585 Schooner Lane | 4,865,000 | 5,620 | 866 |
| 500 Ketch Lane | 1,449,000 | 3,329 | 435 |
| 513 Ketch Lane | 2,100,000 | 4,800 | 438 |
| 549 Sloop Lane | 2,500,000 | 5,000 | 500 |

PENDING LISTINGS

| | PRICE | SQ. FT. | PRICE/SQ. FT. |
|----------------------------|------------------|--------------|---------------|
| 511 Golf Links Lane | \$799,000 | 2,069 | \$386 |
| 531 Ranger Lane | 1,695,900 | 3,389 | 500 |

Roger's listings are highlighted yellow.

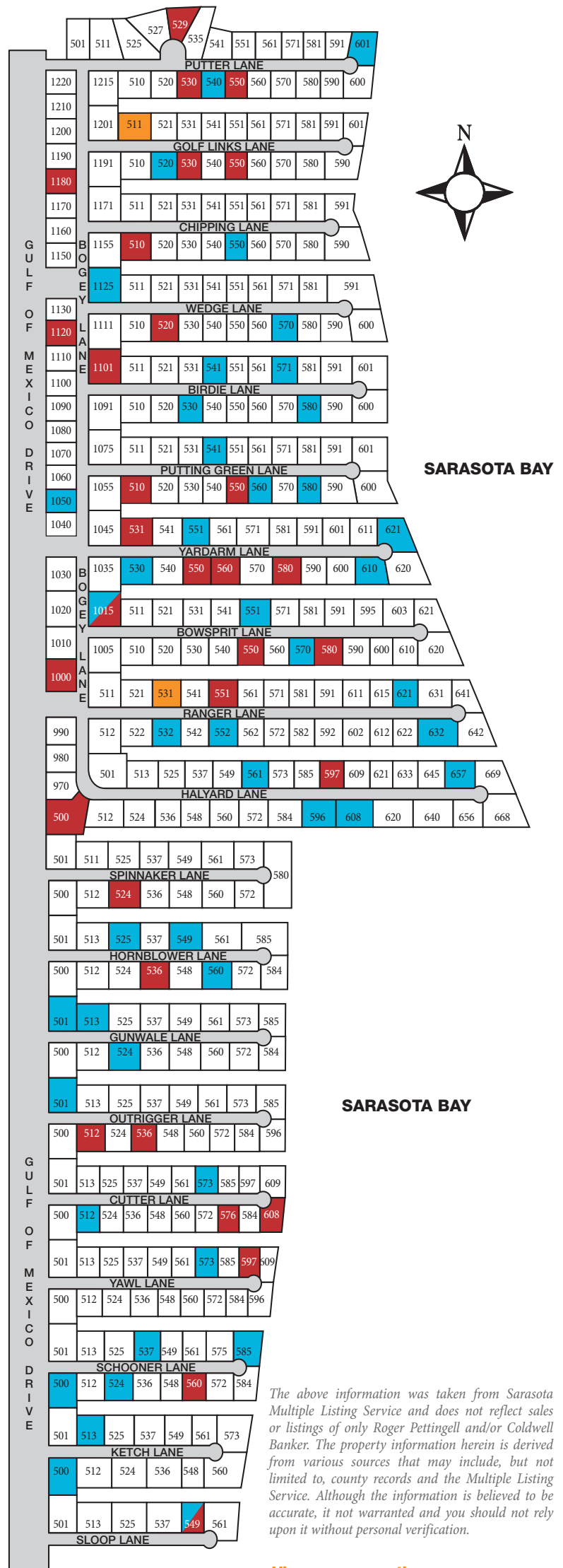

The above information was taken from Sarasota Multiple Listing Service and does not reflect sales or listings of only Roger Pettingell and/or Coldwell Banker. The property information herein is derived from various sources that may include, but not limited to, county records and the Multiple Listing Service. Although the information is believed to be accurate, it not warranted and you should not rely upon it without personal verification.

View our properties on:

floridamoves.com coldwellbanker.com realtor.com
 fl.living.net nytimes.com coldwellbankerpreviews.com





ROGER C. PETTINGELL

office: 941.387.1840 cell: 941.586.6668 toll free: 800.910.8728 fax: 941.387.0173
 e-mail: realroger@comcast.net website: longboatrealstate.com

Luxury Waterfront Specialist

Country Club Shores

► Current Market Analysis
 October 23, 2008

SOLD IN THE PAST 12 MONTHS

| | SOLD PRICE | SQ. FT. | PRICE/SQ. FT. |
|--------------------------|------------------|--------------|---------------|
| 529 Putter Lane | \$3,300,000 | 5,024 | \$657 |
| 530 Putter Lane | 750,000 | 1,922 | 390 |
| 550 Putter Lane | 1,550,000 | 4,104 | 377 |
| 530 Golf Links Lane | 650,000 | 1,886 | 344 |
| 550 Golf Links Lane | 699,000 | 2,322 | 301 |
| 510 Chipping Lane | 680,000 | 1,880 | 359 |
| 1000 Bogey Lane | 320,000 | 1,235 | 259 |
| 1015 Bogey Lane | 2,100,000 | 4,301 | 488 |
| 1101 Bogey Lane | 795,000 | 2,605 | 305 |
| 1120 Bogey Lane | 285,999 | 1,666 | 172 |
| 1180 Bogey Lane | 400,000 | 2,180 | 183 |
| 520 Wedge Lane | 700,000 | 1,958 | 357 |
| 510 Putting Green Lane | 825,000 | 1,815 | 454 |
| 550 Putting Green Lane | 625,000 | 2,129 | 294 |
| 531 Yardarm Lane | 1,750,000 | 4,253 | 411 |
| 550 Yardarm Lane | 1,600,000 | 4,244 | 377 |
| 560 Yardarm Lane | 1,150,000 | 2,989 | 385 |
| 580 Yardarm Lane | 666,000 | 2,332 | 286 |
| 550 Bowsprit Lane | 570,000 | 1,313 | 434 |
| 580 Bowsprit Lane | 814,500 | 2,115 | 385 |
| 551 Ranger Lane | 550,000 | 1,496 | 367 |
| 500 Halyard Lane | 735,000 | 1,951 | 376 |
| 597 Halyard Lane | 1,050,000 | 1,991 | 527 |
| 524 Spinnaker Lane | 1,500,000 | 3,500 | 428 |
| 536 Hornblower Lane | 648,000 | 1,963 | 330 |
| 512 Outrigger Lane | 695,000 | 1,937 | 358 |
| 536 Outrigger Lane | 2,100,000 | | |
| 576 Cutter Lane | 1,100,000 | 2,000 | 550 |
| 608 Cutter Lane | 2,450,000 | 3,350 | 731 |
| 597 Yawl Lane | 1,304,000 | 2,879 | 453 |
| 560 Schooner Lane | 1,250,000 | 3,134 | 398 |
| 549 Sloop Lane | 1,563,485 | 4,127 | 378 |

Roger's listings are highlighted yellow.

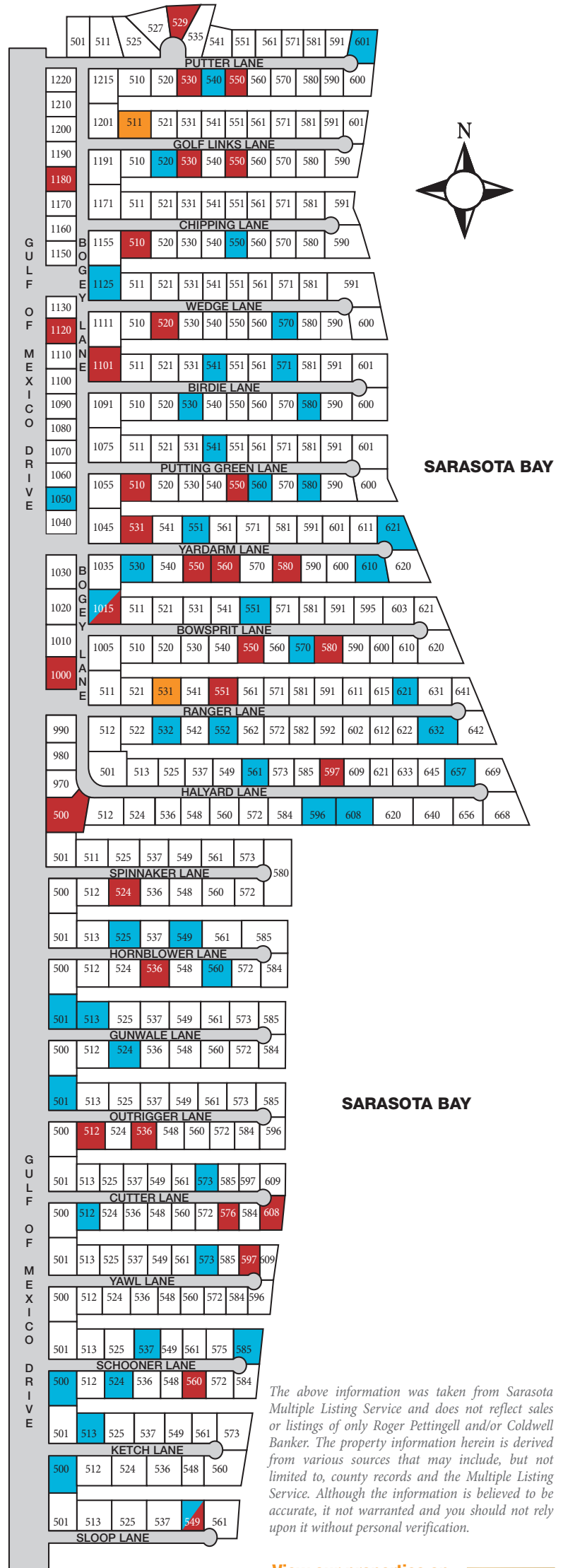

The above information was taken from Sarasota Multiple Listing Service and does not reflect sales or listings of only Roger Pettingell and/or Coldwell Banker. The property information herein is derived from various sources that may include, but not limited to, county records and the Multiple Listing Service. Although the information is believed to be accurate, it not warranted and you should not rely upon it without personal verification.

View our properties on:

floridamoves.com coldwellbanker.com realtor.com
 fl.living.net nytimes.com coldwellbankerpreviews.com

